



project title

drumming up

feel the rhythm

drawing title

outside wayfinding

date

12/08/2017

drawn by

Nina van Styrum
Fall 2017

drawing number

EX 00.07

scale

N/A

location map

-

NOT FOR CONSTRUCTION

These design control drawings represent visual concepts and construction recommendations only. Nina van Styrum does not accept any responsibility for the structural appropriateness or integrity of completed scenic/exhibit structures, and no engineering specifications are implied herein. All materials and construction must comply with the most stringent applicable fire, safety and building codes. Written dimensions shall have precedence over scaled dimensions. If a discrepancy is discovered as to which is correct, the fabricator shall contact Nina van Styrum to determine.

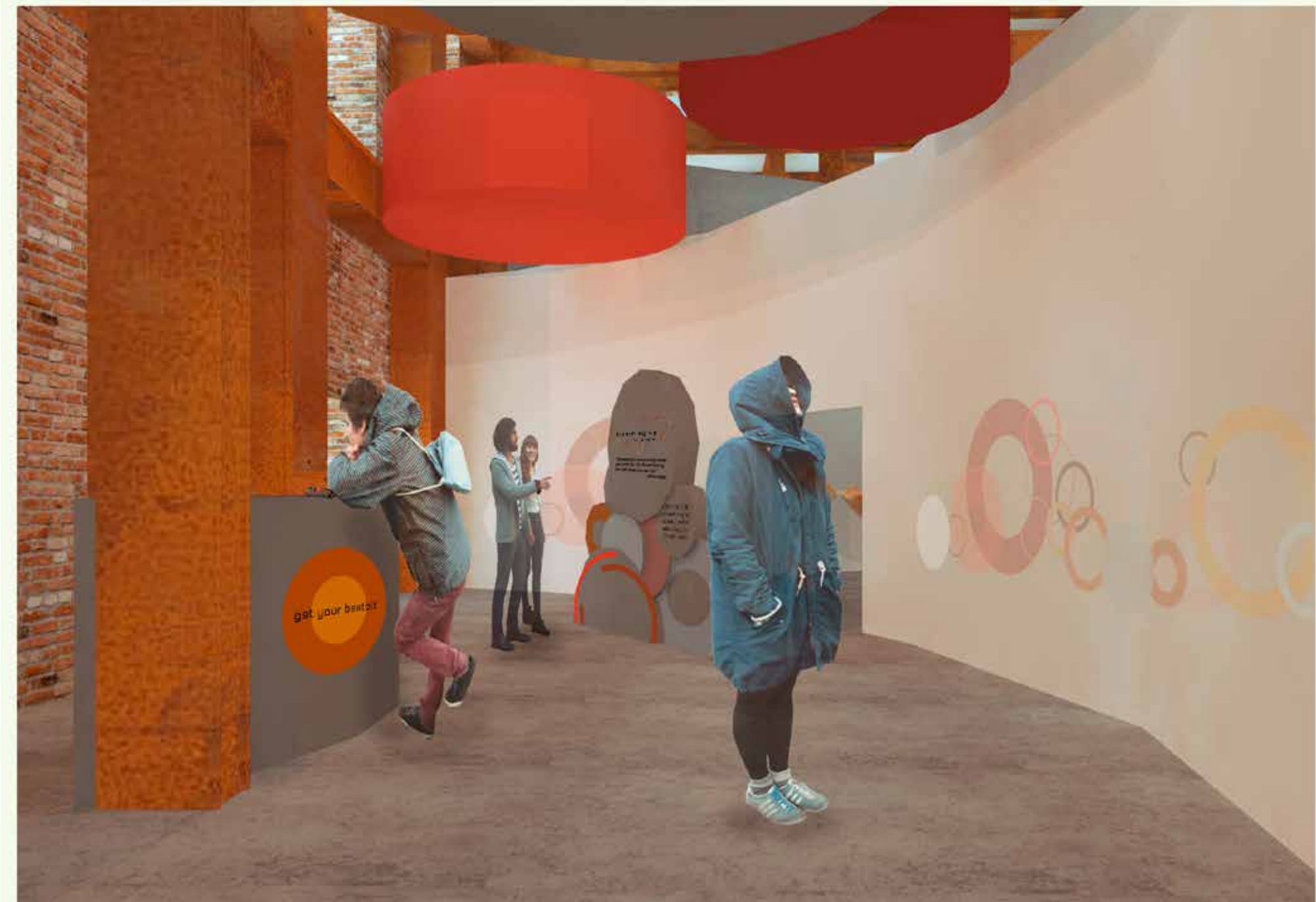

the beat bit
a personal device that visitors receive at the chterentrance. This dicive is an item that will save every sound rhythm and beat they create, as for it being a scanning device for saving every rhythm or beat visitors find interesting. This device can be linked to an interactive table in the last area of the exhibit. All the recorded and saved rhythms and beats can then be heard. At these stations the opportunity to mix and match your rhythm and beats together to make the sound and rhythm you like!

project title

drumming up
feel the rhythm

drawing title
entrance and introduction beat bit

date
12/08/2017

drawn by
Nina van Styrum
Fall 2017

drawing number
EX 00.08

scale
N/A

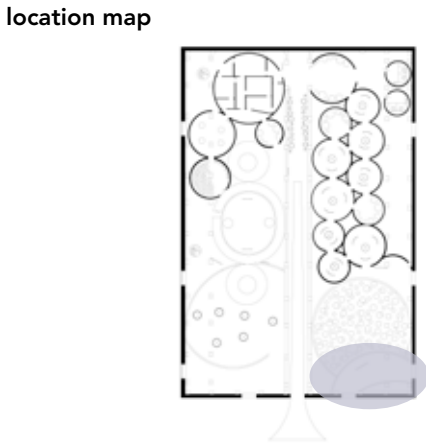

NOT FOR CONSTRUCTION
These design control drawings represent visual concepts and construction recommendations only. Nina van Styrum does not accept any responsibility for the structural appropriateness or integrity of completed scenic/exhibit structures, and no engineering specifications are implied herein. All materials and construction must comply with the most stringent applicable fire, safety and building codes. Written dimensions shall have precedence over scaled dimensions. If a discrepancy is discovered as to which is correct, the fabricator shall contact Nina van Styrum to determine.

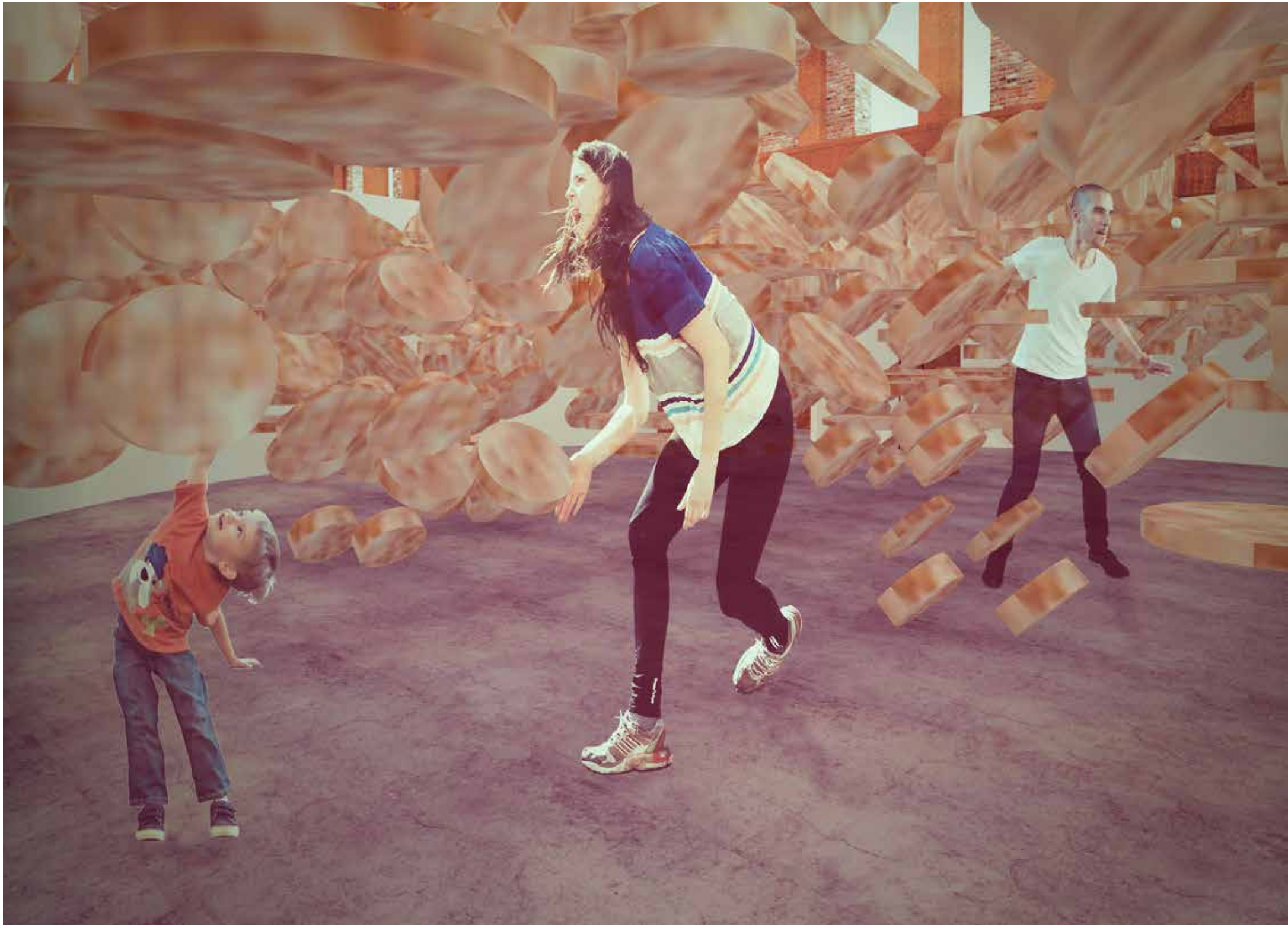

Visitors will see different sized fabricated circels.

Visitors will have an interactive moment of drumming through hitting these circles.

Visitors will experience creation of sound and rhythm

project title



drawing title

entrance - drumforrest

date

12/08/2017

drawn by

Nina van Styrum
Fall 2017

drawing number

EX 00.09

scale

N/A

location map

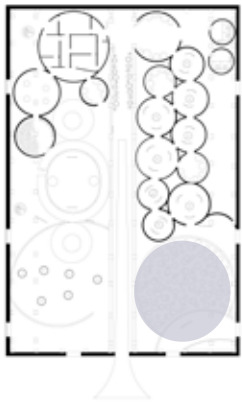

NOT FOR CONSTRUCTION

These design control drawings represent visual concepts and construction recommendations only. Nina van Styrum does not accept any responsibility for the structural appropriateness or integrity of completed scenic/exhibit structures, and no engineering specifications are implied herein. All materials and construction must comply with the most stringent applicable fire, safety and building codes. Written dimensions shall have precedence over scaled dimensions. If a discrepancy is discovered as to which is correct, the fabricator shall contact Nina van Styrum to determine.



Visitors will walk through different circular rooms and see:

- projections of people playing and influences on others
- screens with hearing phones to hear interviews
- timeline
- material of the drum

Visitors will listing and seeing the rhythm creations of drumming from other communities, gathering and drummers through interviews, movies projections, history and visually seeing the drums on display.

Visitors will learn how drums are used in different communities, cultures and gatherings, the meaning behind the rhythm people create with drums and what drums, drumming and its rhythm mean for in different communities, cultures and gatherings.

project title

drumming up

feel the rhythm

drawing title
1 rhythm stories
african tribe

date
12/08/2017

drawn by
Nina van Styrum
Fall 2017

drawing number
EX 00.10

scale
N/A

location map

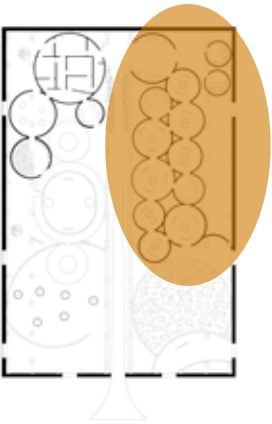

NOT FOR CONSTRUCTION

These design control drawings represent visual concepts and construction recommendations only. Nina van Styrum does not accept any responsibility for the structural appropriateness or integrity of completed scenic/exhibit structures, and no engineering specifications are implied herein. All materials and construction must comply with the most stringent applicable fire, safety and building codes. Written dimensions shall have precedence over scaled dimensions. If a discrepancy is discovered as to which is correct, the fabricator shall contact Nina van Styrum to determine.



from the outside
Visitors will see one big drum circle with the exhibit name/logo on it.

From the inside
Visitors will see a drum horn going toward the outside of the building with a machine next to it showing the decible of a hit.

Visitors will be hitting different rhythms as hard as possible and will be shown shown how hard they hit.

Visitors will learn how hard their rhythm creations are. As for chance of letting others hear their rhythm creations - "let yourself be hear".

project title

drumming up

feel the rhythm

drawing title

2 rhythm creation

drum horn

date

12/08/2017

drawn by

Nina van Styrum

Fall 2017

drawing number

EX 00.11

scale

N/A

location map

NOT FOR CONSTRUCTION

These design control drawings represent visual concepts and construction recommendations only. Nina van Styrum does not accept any responsibility for the structural appropriateness or integrity of completed scenic/exhibit structures, and no engineering specifications are implied herein. All materials and construction must comply with the most stringent applicable fire, safety and building codes. Written dimensions shall have precedence over scaled dimensions. If a discrepancy is discovered as to which is correct, the fabricator shall contact Nina van Styrum to determine.

14



project title

drumming up

feel the rhythm

drawing title

2 rhythm creation

drum horn

date

12/08/2017

drawn by

Nina van Styrum

Fall 2017

drawing number

EX 00.12

scale

N/A

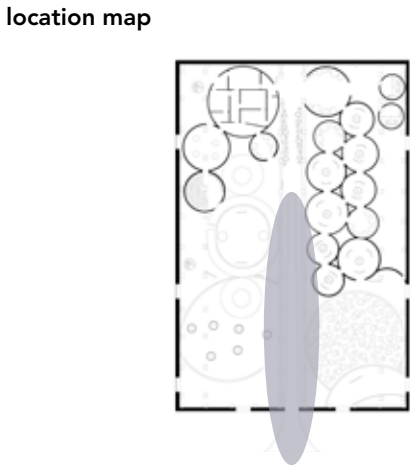

NOT FOR CONSTRUCTION

These design control drawings represent visual concepts and construction recommendations only. Nina van Styrum does not accept any responsibility for the structural appropriateness or integrity of completed scenic/exhibit structures, and no engineering specifications are implied herein. All materials and construction must comply with the most stringent applicable fire, safety and building codes. Written dimensions shall have precedence over scaled dimensions. If a discrepancy is discovered as to which is correct, the fabricator shall contact Nina van Styrum to determine.

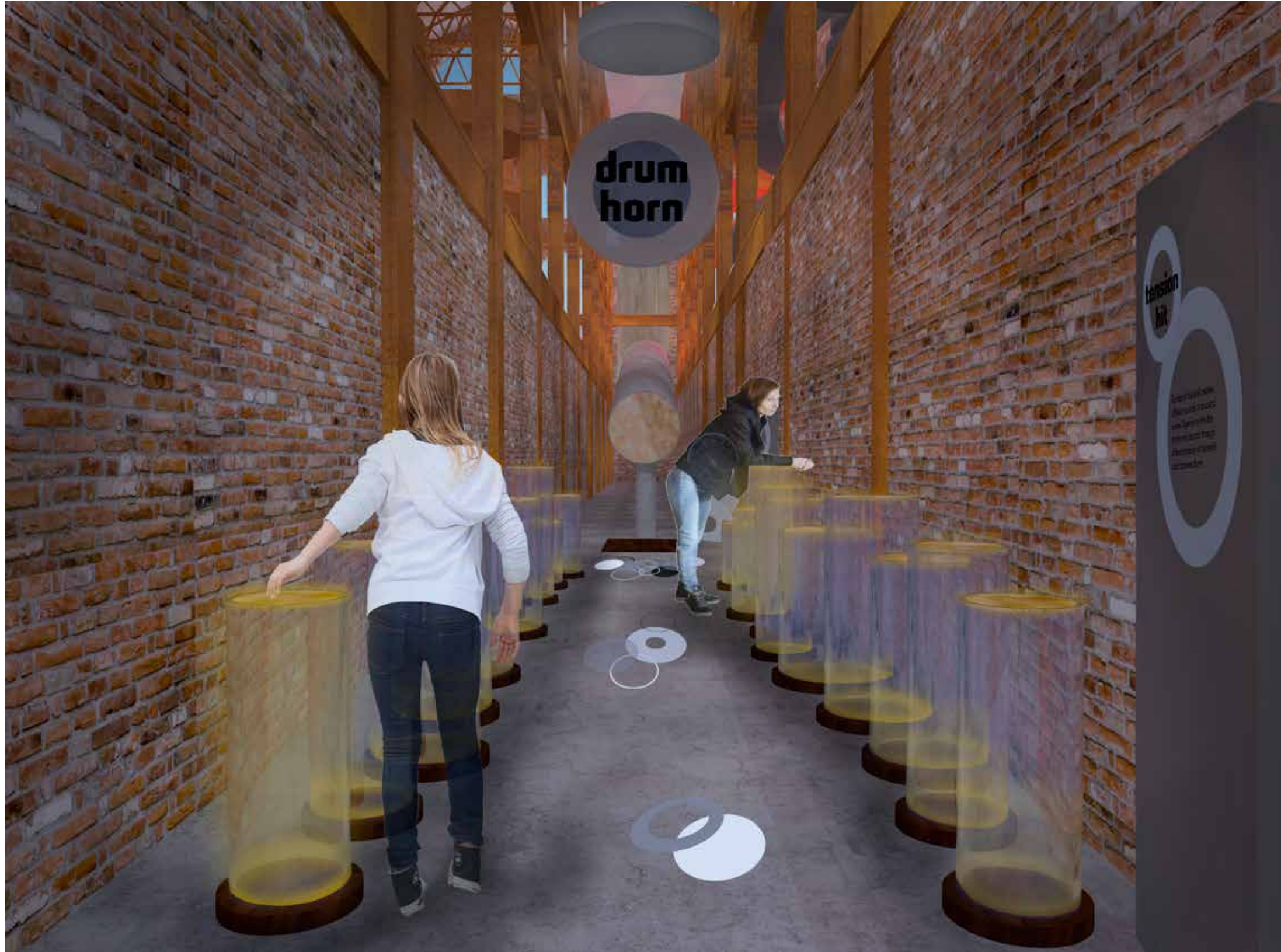

Visitors will see hallow plastic tubes, lighted up, spaned with different materials in the open part of the tubes.

Vistors will walk through hitting the different materials spaned inbetween the tubes and experiencing material tension and its in create rhythms

Visitors will experience and learn how the tension of a material influences the sound andvibrationvof a rhythm during drumming.

project title



drawing title

2 rhythm creation
tension hit

date

12/08/2017

drawn by

Nina van Styrum
Fall 2017

drawing number

EX 00.13

scale

N/A

location map

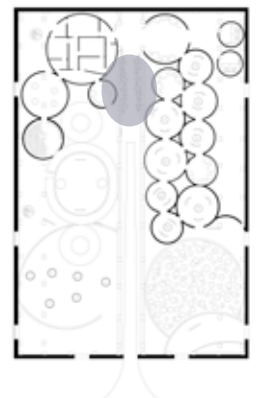

NOT FOR CONSTRUCTION

These design control drawings represent visual concepts and construction recommendations only. Nina van Styrum does not accept any responsibility for the structural appropriateness or integrity of completed scenic/exhibit structures, and no engineering specifications are implied herein. All materials and construction must comply with the most stringent applicable fire, safety and building codes. Written dimensions shall have precedenceover scaled dimensions. If a discrepancy is discovered as to which is correct, the fabricator shall contact Nina van Styrum to determine.



Visitors see different doors and graphics

Visitors will walk through different room and experience the acoustics of the rhythm and sounds that drums create.

Visitors will experience how the acoustics of drumming are in different sized rooms.

project title

drumming up
feel the rhythm

drawing title

2 rhythm creation
acoustic maze

date

12/08/2017

drawn by

Nina van Styrum
Fall 2017

drawing number

EX 00.14

scale

N/A

location map

NOT FOR CONSTRUCTION

These design control drawings represent visual concepts and construction recommendations only. Nina van Styrum does not accept any responsibility for the structural appropriateness or integrity of completed scenic/exhibit structures, and no engineering specifications are implied herein. All materials and construction must comply with the most stringent applicable fire, safety and building codes. Written dimensions shall have precedence over scaled dimensions. If a discrepancy is discovered as to which is correct, the fabricator shall contact Nina van Styrum to determine.

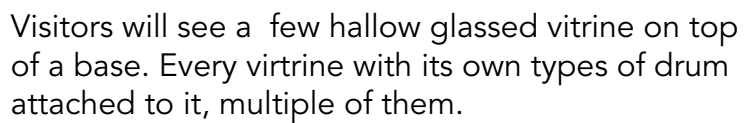

Vistors learn how to drum in synchronization and how this works through different drums and their sounds and rhythms.



drumming up
feel the rhythm

2 rhythm creation

brain wave synchronize

drawn by
Nina van Styrum
Fall 2017

scale	N/A
-------	-----

These design control drawings represent visual concepts and construction recommendations only. Nina van Styrum does not accept any responsibility for the structural appropriateness or integrity of completed scenic/exhibit structures, and no engineering specifications are implied herein. All materials and construction must comply with the most stringent applicable fire, safety and building codes. Written dimensions shall have precedence over scaled dimensions. If a discrepancy is discovered as to which is correct, the fabricator shall contact Nina van Styrum to determine.



Visitors will see a room filled with round lighted up circels.

Visitors will have the opportunity to step, walk and hit the circels with their feet and hands.

Visitors will learn how electric drums work and what type of rhythm and sound it creates.

project title

drumming up

feel the rhythm

drawing title

2 rhythm creation

electronic battle

date

12/08/2017

drawn by

Nina van Styrum

Fall 2017

drawing number

EX 00.16

scale

N/A

location map

NOT FOR CONSTRUCTION

These design control drawings represent visual concepts and construction recommendations only. Nina van Styrum does not accept any responsibility for the structural appropriateness or integrity of completed scenic/exhibit structures, and no engineering specifications are implied herein. All materials and construction must comply with the most stringent applicable fire, safety and building codes. Written dimensions shall have precedence over scaled dimensions. If a discrepancy is discovered as to which is correct, the fabricator shall contact Nina van Styrum to determine.



Visitors will see an area filled with drums and four smaller activities around it, surrounded by a ramp.

visitors will drum on all different types of drums as for hearing drumming rhythm and beats.

Visitors will learn and experience how drumming and and listing to drums has effect on the human body and mind.

project title

drumming up

feel the rhythm

drawing title

2 rhythm creation

heart beat be seen & ramp

date

12/08/2017

drawn by

Nina van Styrum

Fall 2017

drawing number

EX 00.17

scale

N/A

location map

NOT FOR CONSTRUCTION

These design control drawings represent visual concepts and construction recommendations only. Nina van Styrum does not accept any responsibility for the structural appropriateness or integrity of completed scenic/exhibit structures, and no engineering specifications are implied herein. All materials and construction must comply with the most stringent applicable fire, safety and building codes. Written dimensions shall have precedence over scaled dimensions. If a discrepancy is discovered as to which is correct, the fabricator shall contact Nina van Styrum to determine.



project title



drawing title

2 rhythm creation
heart beat be seen & ramp

date

12/08/2017

drawn by

Nina van Styrum
Fall 2017

drawing number

EX 00.18

scale

N/A

location map

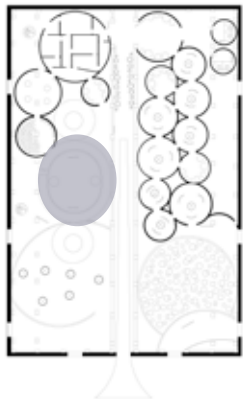

NOT FOR CONSTRUCTION

These design control drawings represent visual concepts and construction recommendations only. Nina van Styrum does not accept any responsibility for the structural appropriateness or integrity of completed scenic/exhibit structures, and no engineering specifications are implied herein. All materials and construction must comply with the most stringent applicable fire, safety and building codes. Written dimensions shall have precedence over scaled dimensions. If a discrepancy is discovered as to which is correct, the fabricator shall contact Nina van Styrum to determine.



Visitors will see different interactive tables with speaker bubbles above them.



Visitors will link the beatbit to the interactive table, and have the opportunity to mix and match recorded and saved rhythms to create their sound of rhythm.

Visitors will learn to connect, create, discover, make and share!

project title



drawing title
3 rhythm station

date
12/08/2017

drawn by
Nina van Styrum
Fall 2017

drawing number
EX 00.19

scale
N/A

location map

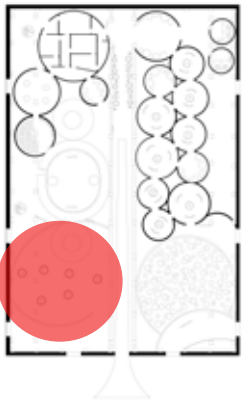

NOT FOR CONSTRUCTION

These design control drawings represent visual concepts and construction recommendations only. Nina van Styrum does not accept any responsibility for the structural appropriateness or integrity of completed scenic/exhibit structures, and no engineering specifications are implied herein. All materials and construction must comply with the most stringent applicable fire, safety and building codes. Written dimensions shall have precedence over scaled dimensions. If a discrepancy is discovered as to which is correct, the fabricator shall contact Nina van Styrum to determine.

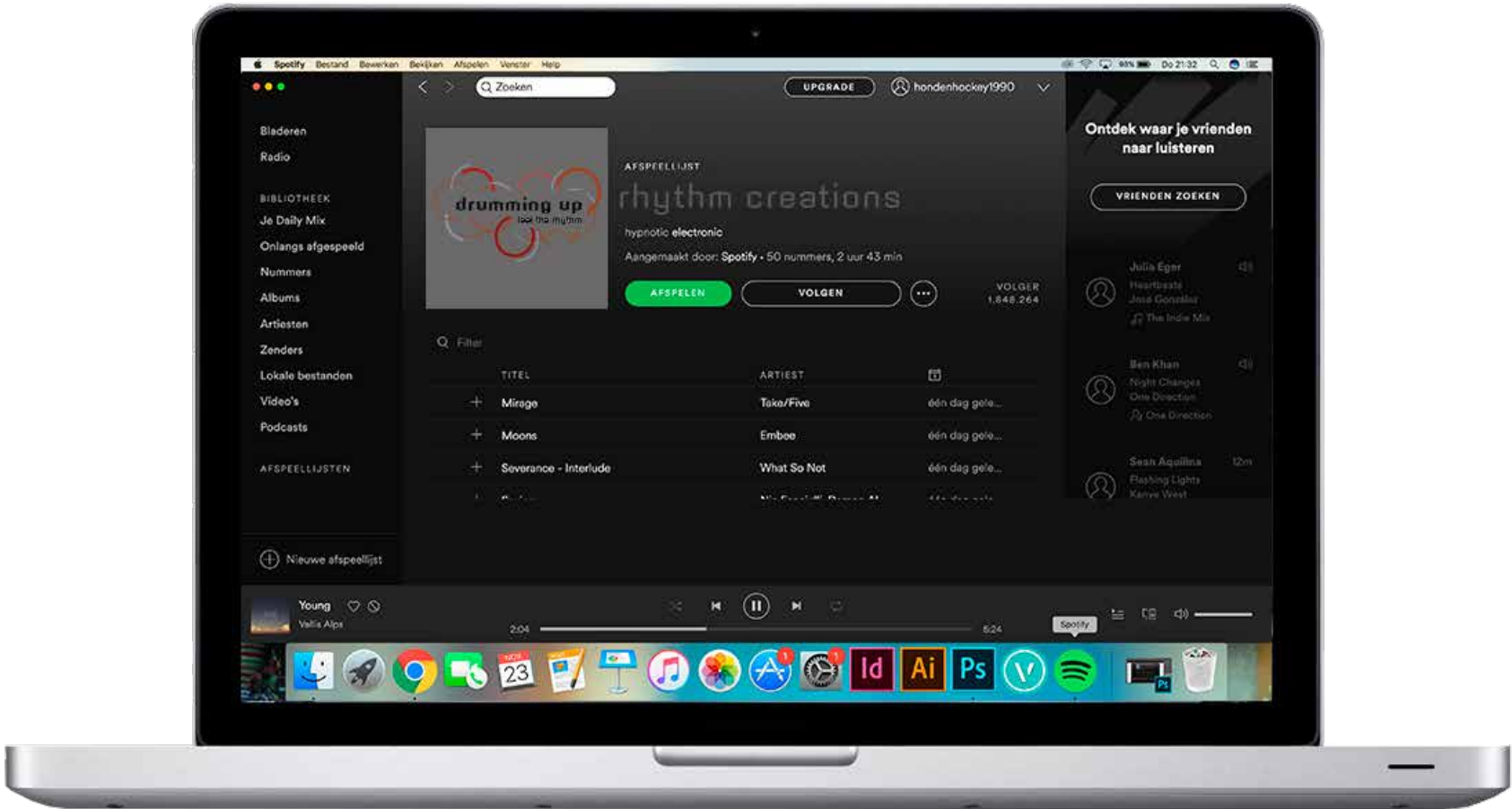

drawing title
post visit experience

date
12/08/2017

drawn by
Nina van Styrum
Fall 2017

drawing number
EX 00.20

scale
N/A

location map
-

NOT FOR CONSTRUCTION

These design control drawings represent visual concepts and construction recommendations only. Nina van Styrum does not accept any responsibility for the structural appropriateness or integrity of completed scenic/exhibit structures, and no engineering specifications are implied herein. All materials and construction must comply with the most stringent applicable fire, safety and building codes. Written dimensions shall have precedence over scaled dimensions. If a discrepancy is discovered as to which is correct, the fabricator shall contact Nina van Styrum to determine.